

Plat of Survey

Tax Parcel AAG 00011A

located in the Northeast 1/4 of the Northwest 1/4 of Section 6-1-15,
North, Range 15 East, Town of Sharon, Walworth County, Wisconsin.

Legal Description
Lots 1 through 13 in Block 7, ALSO the vacated alley* in said Block 7, ALSO that portion of the South 1/2 of vacated John Street lying North of said Lots 1 through 9, ALSO, that portion of vacated Allen Street lying West of said Block 7 and lying West of said South 1/2 of vacated John Street, all in the Original Plat of the Village of Allen's Grove, located in the Northeast 1/4 of the Northwest 1/4 of Section 6, Town 1 North, Range 15 East, Town of Sharon, Walworth County, Wisconsin.

Copyright ©2020 by Olson Land Surveying, LLC.

All rights reserved. No part of this survey plat may be reproduced or transmitted in any form by any means - graphic, electronic, or mechanical, including photocopying, tracing, or information storage and retrieval systems - without permission in writing from Douglas G. Olson, Olson Land Surveying, LLC.

I hereby certify that I have surveyed the above described property in compliance with Chapter A-E 7 of the Wisconsin Administrative Code and that the map hereon is correct to the best of my professional knowledge and belief and shows the size and location of the property, its exterior boundaries, the location and dimensions of all visible structures thereon, boundary fences, apparent easements and roadways and visible encroachments, if any.

This survey is made for the exclusive use of the present owners of the property, and also those who purchase, mortgage or guarantee title thereto, within one year from the date hereof.

Douglas G. Olson
Wisconsin Professional Land Surveyor - 2093

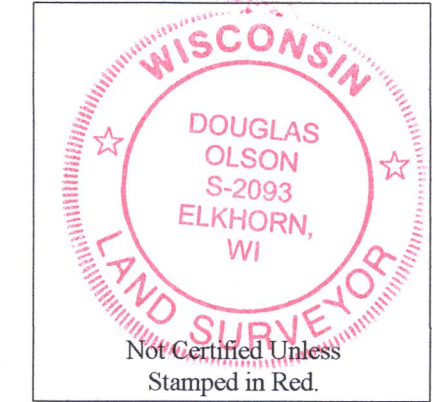

Notes:

- 1) This Plat of Survey is not certified unless signed and sealed in red ink.
- 2) This survey is subject to Wisconsin lien laws. This Plat of Survey is the notice of intent to file lien. Lien waiver required.
- 3) The Survey Date shown on this Plat of Survey is the completion date of the field work.

Notes:

- A) A concrete monument was set to mark this section corner in November of 1984. The monument was moved 1.81, South onto the township line in December of 1995. Record dimensions shown on surveys done between 1984 and 1995 are different than dimensions measured to the current monument location.
- * B) There are some deeds and prior surveys that refer to the Alley in Block 6 as vacated. The Walworth County GIS appears to show the Alleys in both Block 6 & Block 7 as vacated. We were unable to verify with recorded docs.
- C) Allen Street vacated by Doc. No. 1025515 and John Street vacated by Doc. No. 1025514.

Bearings referenced to the North line of the Northwest 1/4 of Section 6-1-15, recorded as N89°03'32"E in the Wisconsin State Plane Coordinate System, South Zone, (NAD-27).

Coordinates are referenced to the Wisconsin State Plane Coordinate System, South Zone, (NAD-27).

Survey Date: October 8, 2020.

Revisions:
No. 1 - Parcels after Street
No. 2 - Proposed Lot Line
No. 3 - Adjustment 00011, after
No. 4 - Recorded Street Vacation
No. 5a - Wetland Delineation

Scale in Feet
1" = 40'

45 South Wisconsin Street | P.O. Box 322
Elkhorn, Wisconsin 53121
Telephone: 262.723.3434
Facsimile: 262.723.8044
Email: doug@olsonsurveying.com
Website: www.olsonsurveying.com

OLSON
LAND SURVEYING, LLC
Rural | Residential | Commercial

North
South
West
East
Bearing
Minutes
Seconds
Inches
Feet

Legend of Symbols & Abbreviations
Found County Section Corner
Found Iron Pipe
Found Iron Rod
Found Iron Nail
Found Iron Pin
Found Iron Bolt
Found Iron Screw
Found Iron Nut
Found Iron Washer
Found Iron Plate
Found Iron Band
Found Iron Strap
Found Iron Chain
Found Iron Link
Found Iron Ring
Found Iron Ball
Found Iron Disk
Found Iron Cylinder
Found Iron Cone
Found Iron Pyramid
Found Iron Sphere
Found Iron Cube
Found Iron Box
Found Iron Can
Found Iron Jar
Found Iron Pot
Found Iron Kettle
Found Iron Bucket
Found Iron Pail
Found Iron Tub
Found Iron Barrel
Found Iron Cask
Found Iron Drum
Found Iron Keg
Found Iron Hogshead
Found Iron Cask
Found Iron Barrel
Found Iron Drum
Found Iron Keg
Found Iron Hogshead

Sheet 1 of 1 Sheets
Drawing Name:
Job Reference Number
2020.099

Center 1/4 Corner
Section 6-1-15
N. 210.916.32
E. 2.332.244.78
115-496

2020.099